

Kabelstecker
Male cable connector

Kabelstecker 360° EMV sicher, schirmbar
Male cable connector 360° EMI protected, shieldable

Kabelstecker, Irisfeder
Male cable connector, iris type spring

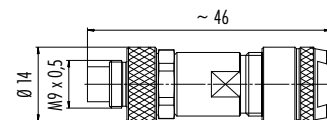
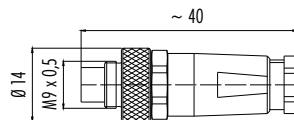
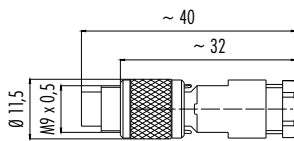

Polzahl Contacts	Kabeldurchlass Cable outlet	Bestell-Nr. Ordering-No.
2	3,5–5 mm	99 0401 00 02
3	3,5–5 mm	99 0405 00 03
4	3,5–5 mm	99 0409 00 04
5	3,5–5 mm	99 0413 00 05
7	3,5–5 mm	99 0421 00 07
8	3,5–5 mm	99 0425 00 08

Polzahl Contacts	Kabeldurchlass Cable outlet	Bestell-Nr. Ordering-No.
2	3,5–5 mm	99 0401 10 02
3	3,5–5 mm	99 0405 10 03
4	3,5–5 mm	99 0409 10 04
5	3,5–5 mm	99 0413 10 05
7	3,5–5 mm	99 0421 10 07
8	3,5–5 mm	99 0425 10 08

Polzahl Contacts	Kabeldurchlass Cable outlet	Bestell-Nr. Ordering-No.
2	4–5,5 mm	99 0401 115 02
3	4–5,5 mm	99 0405 115 03
4	4–5,5 mm	99 0409 115 04
5	4–5,5 mm	99 0413 115 05
7	4–5,5 mm	99 0421 115 07
8	4–5,5 mm	99 0425 115 08

Polzahl	2	3	4	5	7	8	Number of contacts
Steckverbinder Verriegelung	schrauben/screw						Connector locking system
Anschlussart	löten/solder						Termination
Anschlussquerschnitt	max. 0,25 mm ² (max. AWG 24)				max. 0,14 mm ² (max. AWG 26)		Wire gauge
Kabeldurchlass	3,5–5 mm, 4–5,5 mm						Cable outlet
Schutzart	IP67						Degree of protection
Mechanische Lebensdauer	> 500 Steckzyklen/> 500 mating cycles						Mechanical operation
Obere Grenztemperatur	+ 85 °C						Upper temperature
Untere Grenztemperatur	– 40 °C						Lower temperature
Bemessungsspannung	125 V						Rated voltage
Bemessungs-Stoßspannung	1500 V						Rated impulse voltage
Verschmutzungsgrad	1						Pollution degree
Überspannungskategorie	II						Overvoltage categorie
Isolierstoffgruppe	III						Material group
Bemessungsstrom (40°C)	4 A		3 A		1 A		Rated current (40 °C)
Material Kontakt	CuZn (Messing/brass)						Material of contact
Kontaktoberfläche	Au (Gold/gold)						Contact plating
Material Kontaktkörper	PBT						Material of contact body
Material Gehäuse	PA, CuZn (Messing vernickelt/brass nickel plated)						Material of housing
Material Verriegelung	CuZn (Messing/brass)						Material of locking

Winkelstecker
Male angled connector

Winkelstecker 360° EMV sicher, schirmbar
Male angled connector 360° EMI protected, shieldable

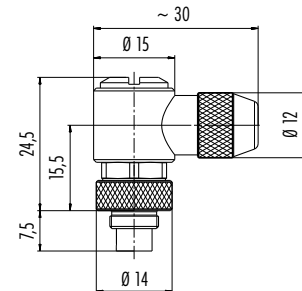
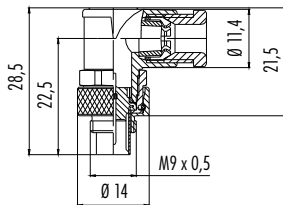

Polzahl Contacts	Kabeldurchlass Cable outlet	Bestell-Nr. Ordering-No.	Polzahl Contacts	Kabeldurchlass Cable outlet	Bestell-Nr. Ordering-No.
2	3,5–5 mm	99 0401 70 02	2	3,5–5 mm	99 0401 75 02
3	3,5–5 mm	99 0405 70 03	3	3,5–5 mm	99 0405 75 03
4	3,5–5 mm	99 0409 70 04	4	3,5–5 mm	99 0409 75 04
5	3,5–5 mm	99 0413 70 05	5	3,5–5 mm	99 0413 75 05
7	3,5–5 mm	99 0421 70 07	7	3,5–5 mm	99 0421 75 07
8	3,5–5 mm	99 0425 70 08	8	3,5–5 mm	99 0425 75 08

Polzahl	2	3	4	5	7	8	Number of contacts
Steckverbinder Verriegelung	schrauben/screw						Connector locking system
Anschlussart	löten/solder						Termination
Anschlussquerschnitt	max. 0,25 mm ² (max. AWG 24)			max. 0,14 mm ² (max. AWG 26)			Wire gauge
Kabeldurchlass	3,5 –5 mm						Cable outlet
Schutzart	IP67						Degree of protection
Mechanische Lebensdauer	> 500 Steckzyklen/> 500 mating cycles						Mechanical operation
Obere Grenztemperatur	+ 85 °C						Upper temperature
Untere Grenztemperatur	– 40 °C						Lower temperature
Bemessungsspannung	125 V						Rated voltage
Bemessungs-Stoßspannung	1500 V						Rated impulse voltage
Verschmutzungsgrad	1						Pollution degree
Überspannungskategorie	II						Overvoltage categorie
Isolierstoffgruppe	III						Material group
Bemessungsstrom (40°C)	4 A		3 A		1 A		Rated current (40 °C)
Material Kontakt	CuZn (Messing/brass)						Material of contact
Kontaktoberfläche	Au (Gold/gold)						Contact plating
Material Kontaktkörper	PBT						Material of contact body
Material Gehäuse	PA, CuZn (Messing vernickelt/brass nickel plated)						Material of housing
Material Verriegelung	CuZn (Messing/brass)						Material of locking

Kabeldose
Female cable connector

Kabeldose 360° EMV sicher, schirmbar
Female cable connector 360° EMI protected, shieldable

Kabeldose, Irisfeder
Female cable connector, iris type spring

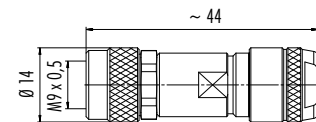
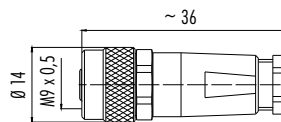
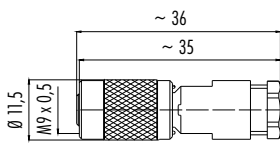

Polzahl Contacts	Kabeldurchlass Cable outlet	Bestell-Nr. Ordering-No.
2	3,5–5 mm	99 0402 00 02
3	3,5–5 mm	99 0406 00 03
4	3,5–5 mm	99 0410 00 04
5	3,5–5 mm	99 0414 00 05
7	3,5–5 mm	99 0422 00 07
8	3,5–5 mm	99 0426 00 08

Polzahl Contacts	Kabeldurchlass Cable outlet	Bestell-Nr. Ordering-No.
2	3,5–5 mm	99 0402 10 02
3	3,5–5 mm	99 0406 10 03
4	3,5–5 mm	99 0410 10 04
5	3,5–5 mm	99 0414 10 05
7	3,5–5 mm	99 0422 10 07
8	3,5–5 mm	99 0426 10 08

Polzahl Contacts	Kabeldurchlass Cable outlet	Bestell-Nr. Ordering-No.
2	4–5,5 mm	99 0402 115 02
3	4–5,5 mm	99 0406 115 03
4	4–5,5 mm	99 0410 115 04
5	4–5,5 mm	99 0414 115 05
7	4–5,5 mm	99 0422 115 07
8	4–5,5 mm	99 0426 115 08

Polzahl	2	3	4	5	7	8	Number of contacts
Steckverbinder Verriegelung	schrauben/screw						Connector locking system
Anschlussart	löten/solder						Termination
Anschlussquerschnitt	max. 0,25 mm ² (max. AWG 24)				max. 0,14 mm ² (max. AWG 26)		Wire gauge
Kabeldurchlass	3,5–5 mm, 4–5,5 mm						Cable outlet
Schutzart	IP67						Degree of protection
Mechanische Lebensdauer	> 500 Steckzyklen/> 500 mating cycles						Mechanical operation
Obere Grenztemperatur	+ 85 °C						Upper temperature
Untere Grenztemperatur	– 40 °C						Lower temperature
Bemessungsspannung	125 V						Rated voltage
Bemessungs-Stoßspannung	1500 V						Rated impulse voltage
Verschmutzungsgrad	1						Pollution degree
Überspannungskategorie	II						Overvoltage categorie
Isolierstoffgruppe	III						Material group
Bemessungsstrom (40°C)	4 A		3 A		1 A		Rated current (40 °C)
Material Kontakt	CuSn (Bronze/bronze)						Material of contact
Kontaktoberfläche	Au (Gold/gold)						Contact plating
Material Kontaktkörper	PA						Material of contact body
Material Gehäuse	PA, CuZn (Messing vernickelt/brass nickel plated)						Material of housing
Material Verriegelung	CuZn (Messing/brass)						Material of locking

Winkeldose
Female angled connector

Winkeldose 360° EMV sicher, schirmbar
Female angled connector 360° EMI protected, shieldable

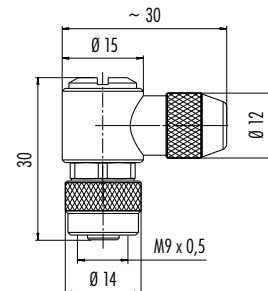
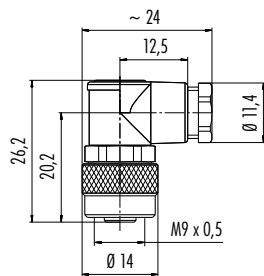

Polzahl Contacts	Kabeldurchlass Cable outlet	Bestell-Nr. Ordering-No.
2	3,5–5 mm	99 0402 70 02
3	3,5–5 mm	99 0406 70 03
4	3,5–5 mm	99 0410 70 04
5	3,5–5 mm	99 0414 70 05
7	3,5–5 mm	99 0422 70 07
8	3,5–5 mm	99 0426 70 08

Polzahl Contacts	Kabeldurchlass Cable outlet	Bestell-Nr. Ordering-No.
2	3,5–5 mm	99 0402 75 02
3	3,5–5 mm	99 0406 75 03
4	3,5–5 mm	99 0410 75 04
5	3,5–5 mm	99 0414 75 05
7	3,5–5 mm	99 0422 75 07
8	3,5–5 mm	99 0426 75 08

Polzahl	2	3	4	5	7	8	Number of contacts
Steckverbinder Verriegelung	schrauben/screw						Connector locking system
Anschlussart	löten/solder						Termination
Anschlussquerschnitt	max. 0,25 mm ² (max. AWG 24)			max. 0,14 mm ² (max. AWG 26)			Wire gauge
Kabeldurchlass	3,5 –5 mm						Cable outlet
Schutzart	IP67						Degree of protection
Mechanische Lebensdauer	> 500 Steckzyklen/> 500 mating cycles						Mechanical operation
Obere Grenztemperatur	+ 85 °C						Upper temperature
Untere Grenztemperatur	– 40 °C						Lower temperature
Bemessungsspannung	125 V						Rated voltage
Bemessungs-Stoßspannung	1500 V						Rated impulse voltage
Verschmutzungsgrad	1						Pollution degree
Überspannungskategorie	II						Overvoltage categorie
Isolierstoffgruppe	III						Material group
Bemessungsstrom (40°C)	4 A		3 A		1 A		Rated current (40 °C)
Material Kontakt	CuZn (Messing/brass)						Material of contact
Kontaktoberfläche	Au (Gold/gold)						Contact plating
Material Kontaktkörper	PA						Material of contact body
Material Gehäuse	PA, CuZn (Messing vernickelt/brass nickel plated)						Material of housing
Material Verriegelung	CuZn (Messing/brass)						Material of locking

Flanschstecker, löten
Male panel mount connector, solder

Flanschstecker, löten, von vorn verschraubbar
Male panel mount connector, solder, front fastened

Flanschstecker, tauchlöten, von vorn verschraubbar
Male panel mount connector, dip solder, front fastened

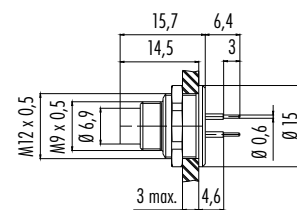
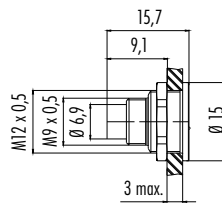
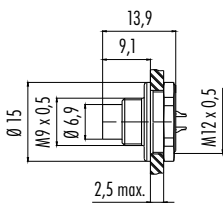

Polzahl Contacts	Bestell-Nr. Ordering-No.
2	09 0403 00 02
3	09 0407 00 03
4	09 0411 00 04
5	09 0415 00 05
7	09 0423 00 07
8	09 0427 00 08

Polzahl Contacts	Bestell-Nr. Ordering-No.
2	09 0403 80 02
3	09 0407 80 03
4	09 0411 80 04
5	09 0415 80 05
7	09 0423 80 07
8	09 0427 80 08

Polzahl Contacts	Bestell-Nr. Ordering-No.
2	09 0403 90 02
3	09 0407 90 03
4	09 0411 90 04
5	09 0415 90 05
7	09 0423 90 07
8	09 0427 90 08

Polzahl	2	3	4	5	7	8	Number of contacts
Steckverbinder Verriegelung	schrauben/screw						Connector locking system
Anschlussart	löten/tauchlöten/solder/dip solder						Termination
Anschlussquerschnitt	max. 0,25 mm ² (max. AWG 24)/ —			max. 0,14 mm ² (max. AWG 26)/ —			Wire gauge
Kabeldurchlass	—						Cable outlet
Schutzart	IP67						Degree of protection
Mechanische Lebensdauer	> 500 Steckzyklen/> 500 mating cycles						Mechanical operation
Obere Grenztemperatur	+ 85 °C						Upper temperature
Untere Grenztemperatur	- 40 °C						Lower temperature
Bemessungsspannung	125 V						Rated voltage
Bemessungs-Stoßspannung	1500 V						Rated impulse voltage
Verschmutzungsgrad	1						Pollution degree
Überspannungskategorie	II						Overvoltage categorie
Isolierstoffgruppe	III						Material group
Bemessungsstrom (40°C)	4 A		3 A		1 A		Rated current (40 °C)
Material Kontakt	CuZn (Messing/brass)						Material of contact
Kontaktoberfläche	Au (Gold/gold)						Contact plating
Material Kontaktkörper	PBT						Material of contact body
Material Gehäuse	CuZn (Messing vernickelt/brass nickel plated)						Material of housing
Material Verriegelung	—						Material of locking

Flanschstecker, tauchlöten, von vorn verschraubbar,
Schirmblech 6 mm
Male panel mount connector, dip solder, front fastened,
shielding sheet 6 mm



Bohrbilder siehe Seite 53
Drilling schemes see page 53

Flanschstecker, tauchlöten, von vorn verschraubbar,
Schirmblech 10 mm
Male panel mount connector, dip solder, front fastened,
shielding sheet 10 mm



Bohrbilder siehe Seite 53
Drilling schemes see page 53

Flanschstecker mit flexibler Leiterplatte
Male panel mount connector with flexible PCB

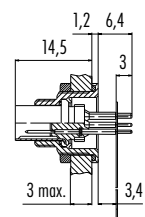
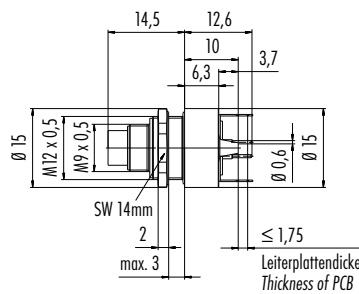
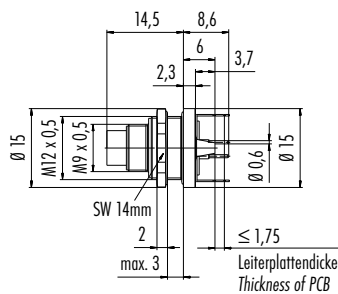

Polzahl Contacts	Bestell-Nr. Ordering-No.
2	09 0403 30 02
3	09 0407 30 03
4	09 0411 30 04
5	09 0415 30 05
7	09 0423 30 07
8	09 0427 30 08

Polzahl Contacts	Bestell-Nr. Ordering-No.
2	09 0403 35 02
3	09 0407 35 03
4	09 0411 35 04
5	09 0415 35 05
7	09 0423 35 07
8	09 0427 35 08

Polzahl Contacts	Bestell-Nr. Ordering-No.
2	—
3	—
4	—
5	—
7	09 0423 65 07
8	09 0427 65 08

Polzahl	2	3	4	5	7	8	Number of contacts
Steckverbinder Verriegelung	schrauben/screw						Connector locking system
Anschlussart	löten/tauchlöten/solder/dip solder						Termination
Anschlussquerschnitt	—						Wire gauge
Kabeldurchlass	—						Cable outlet
Schutzart	IP67						Degree of protection
Mechanische Lebensdauer	> 500 Steckzyklen/> 500 mating cycles						Mechanical operation
Obere Grenztemperatur	+ 85 °C						Upper temperature
Untere Grenztemperatur	- 40 °C						Lower temperature
Bemessungsspannung	125 V						Rated voltage
Bemessungs-Stoßspannung	1500 V						Rated impulse voltage
Verschmutzungsgrad	1						Pollution degree
Überspannungskategorie	II						Overvoltage categorie
Isolierstoffgruppe	III						Material group
Bemessungsstrom (40°C)	4 A		3 A		1 A		Rated current (40 °C)
Material Kontakt	CuZn (Messing/brass)						Material of contact
Kontaktoberfläche	Au (Gold/gold)						Contact plating
Material Kontaktkörper	PBT						Material of contact body
Material Gehäuse	CuZn (Messing vernickelt/brass nickel plated)						Material of housing
Material Verriegelung	—						Material of locking

Flanschdose, löten
Female panel mount connector, solder

Flanschdose, löten, von vorn verschraubbar
Female panel mount connector, solder, front fastened

Flanschdose, tauchlöten, von vorn verschraubbar
Female panel mount connector, dip solder, front fastened

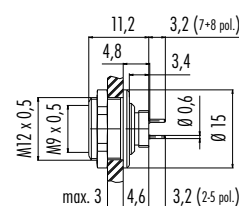
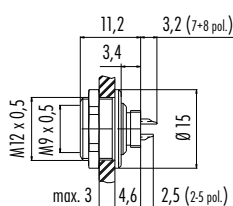
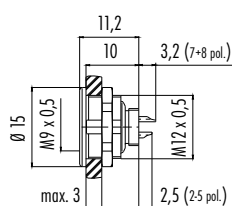

Polzahl Contacts	Bestell-Nr. Ordering-No.
2	09 0404 00 02
3	09 0408 00 03
4	09 0412 00 04
5	09 0416 00 05
7	09 0424 00 07
8	09 0428 00 08

Polzahl Contacts	Bestell-Nr. Ordering-No.
2	09 0404 80 02
3	09 0408 80 03
4	09 0412 80 04
5	09 0416 80 05
7	09 0424 80 07
8	09 0428 80 08

Polzahl Contacts	Bestell-Nr. Ordering-No.
2	09 0404 90 02
3	09 0408 90 03
4	09 0412 90 04
5	09 0416 90 05
7	09 0424 90 07
8	09 0428 90 08

Polzahl	2	3	4	5	7	8	Number of contacts
Steckverbinder Verriegelung	schrauben/screw						Connector locking system
Anschlussart	löten/tauchlöten/solder/dip solder						Termination
Anschlussquerschnitt	max. 0,25 mm ² (max. AWG 24)/ —			max. 0,14 mm ² (max. AWG 26)/ —			Wire gauge
Kabeldurchlass	—						Cable outlet
Schutzart	IP67						Degree of protection
Mechanische Lebensdauer	> 500 Steckzyklen/> 500 mating cycles						Mechanical operation
Obere Grenztemperatur	+ 85 °C						Upper temperature
Untere Grenztemperatur	- 40 °C						Lower temperature
Bemessungsspannung	125 V						Rated voltage
Bemessungs-Stoßspannung	1500 V						Rated impulse voltage
Verschmutzungsgrad	1						Pollution degree
Überspannungskategorie	II						Overvoltage categorie
Isolierstoffgruppe	III						Material group
Bemessungsstrom (40°C)	4 A		3 A		1 A		Rated current (40 °C)
Material Kontakt	CuSn (Bronze/bronze)						Material of contact
Kontaktoberfläche	Au (Gold/gold)						Contact plating
Material Kontaktkörper	PA						Material of contact body
Material Gehäuse	CuZn (Messing vernickelt/brass nickel plated)						Material of housing
Material Verriegelung	—						Material of locking

Flanschdose, tauchlöten, von vorn verschraubbar, Schirmblech 6 mm
Female panel mount connector, dip solder, front fastened, shielding sheet 6 mm



Bohrbilder siehe Seite 53
Drilling schemes see page 53

Flanschdose, tauchlöten, von vorn verschraubbar, Schirmblech 10 mm
Female panel mount connector, dip solder, front fastened, shielding sheet 10 mm



Bohrbilder siehe Seite 53
Drilling schemes see page 53

Flanschdose gewinkelt, tauchlöten, von vorn verschraubbar, Schirmblech
Female angled panel mount connector, dip solder, front fastened, shielding sheet



Bohrbilder siehe Seite 53
Drilling schemes see page 53

Flanschdose mit flexibler Leiterplatte
Female panel mount connector with flexible PCB

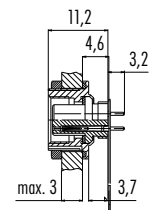
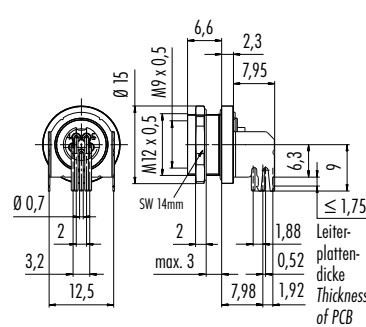
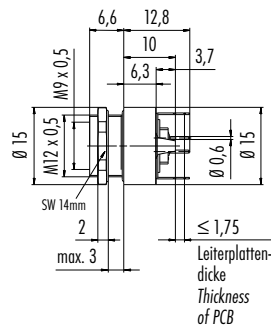
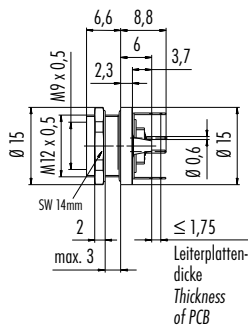

Polzahl Contacts	Bestell-Nr. Ordering-No.	Polzahl Contacts	Bestell-Nr. Ordering-No.	Polzahl Contacts	Bestell-Nr. Ordering-No.	Polzahl Contacts	Bestell-Nr. Ordering-No.
2	09 0404 30 02	2	09 0404 35 02	2	09 0404 55 02	2	—
3	09 0408 30 03	3	09 0408 35 03	3	—	3	—
4	09 0412 30 04	4	09 0412 35 04	4	—	4	—
5	09 0416 30 05	5	09 0416 35 05	5	09 0416 55 05	5	—
7	09 0424 30 07	7	09 0424 35 07	7	—	7	09 0424 65 07
8	09 0428 30 08	8	09 0428 35 08	8	—	8	09 0428 65 08

Polzahl	2	3	4	5	7	8	Number of contacts
Steckverbinder Verriegelung	Bajonett/bayonet						Connector locking system
Anschlussart	tauchlöten/dip solder						Termination
Anschlussquerschnitt	—						Wire gauge
Kabeldurchlass	—						Cable outlet
Schutzart	IP67						Degree of protection
Mechanische Lebensdauer	> 500 Steckzyklen/> 500 mating cycles						Mechanical operation
Obere Grenztemperatur	+ 85 °C						Upper temperature
Untere Grenztemperatur	- 40 °C						Lower temperature
Bemessungsspannung	125 V						Rated voltage
Bemessungs-Stoßspannung	1500 V						Rated impulse voltage
Verschmutzungsgrad	1						Pollution degree
Überspannungskategorie	II						Overvoltage categorie
Isolierstoffgruppe	III						Material group
Bemessungsstrom (40°C)	4 A		3 A		1 A		Rated current (40 °C)
Material Kontakt	CuSn (Bronze/bronze)						Material of contact
Kontaktoberfläche	Au (Gold/gold)						Contact plating
Material Kontaktkörper	PBT						Material of contact body
Material Gehäuse	CuZn (Messing vernickelt/brass nickel plated)						Material of housing
Material Verriegelung	—						Material of locking

Kabelstecker, umspritzt, ungeschirmt
Male cable connector, moulded, unshielded



Winkelstecker, umspritzt, ungeschirmt
Male angled connector, moulded, unshielded



Kabeldose, umspritzt, ungeschirmt
Female cable connector, moulded, unshielded



Winkeldose, umspritzt, ungeschirmt
Female angled connector, moulded, unshielded

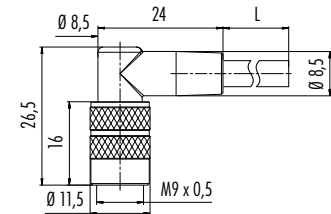
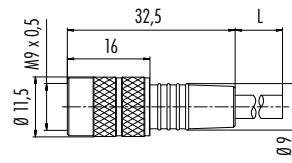
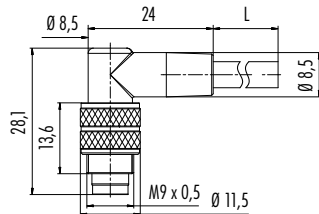
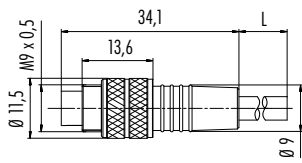

Polzahl Contacts	Kabellänge 2 m Cable length 2 m	Kabellänge 5 m Cable length 5 m	Polzahl Contacts	Kabellänge 2 m Cable length 2 m	Kabellänge 5 m Cable length 5 m	Polzahl Contacts	Kabellänge 2 m Cable length 2 m	Kabellänge 5 m Cable length 5 m	Polzahl Contacts	Kabellänge 2 m Cable length 2 m	Kabellänge 5 m Cable length 5 m
3	79 1451 212 03	79 1451 215 03	3	79 1451 272 03	79 1451 275 03	3	79 1452 212 03	79 1452 215 03	3	79 1452 272 03	79 1452 275 03
5	79 1455 212 05	79 1455 215 05	5	79 1455 272 05	79 1455 275 05	5	79 1456 212 05	79 1456 215 05	5	79 1456 272 05	79 1456 275 05
8	79 1461 212 08	79 1461 215 08	8	79 1461 272 08	79 1461 275 08	8	79 1462 212 08	79 1462 215 08	8	79 1462 272 08	79 1462 275 08

Technische Daten Kabel	3	5	7	Specifications of cable
Querschnitt mm ² ¹⁾	3 x 0,25 mm ² (AWG 24)	5 x 0,25 mm ² (AWG 24)	8 x 0,14 mm ² (AWG 26)	Wire gauge mm ² ¹⁾
Material Mantel	PUR			Material jacket
Isolation Litze	PVC		PVC/PE	Insulation wire
Litzenaufbau (mm)	32 x 0,1		18 x 0,1	Design of wire (mm)
Kabelmantel Ø (mm)	4,5 ^{+0,2}	5 ^{+0,2}		Cable jacket Ø (mm)
Leiterwiderstand	72 Ω/Km (20 °C)	77,5 Ω/Km (20 °C)	117 Ω/Km (20 °C)	Resistance of wire
Temp.-Bereich (Kabel bew.)	- 5 °C /+ 70 °C			Temp. range (cable in move)
Temp.-Bereich (Kabel fest)	- 25 °C /+ 70 °C			Temp. range (cable fixed)
Biegeradius (Kabel bew.)	min. 45 mm	min. 50 mm		Bending radius (cable in move)
Biegeradius (Kabel fest)	min. 22 mm	min. 25 mm		Bending radius (cable fixed)
Zulassung	—			Approval

Polzahl	3	5	8	Number of contacts
Steckverbinder Verriegelung	schrauben/screw			Connector locking system
Anschlussart	am Kabel angespritzt/moulded			Termination
Anschlussquerschnitt	0,25 mm ² (AWG 24)		0,14 mm ² (AWG 26)	Wire gauge
Kabeldurchlass	—			Cable outlet
Schutzart	IP67			Degree of protection
Mechanische Lebensdauer	> 500 Steckzyklen/> 500 mating cycles			Mechanical operation
Obere Grenztemperatur	+ 85 °C			Upper temperature
Untere Grenztemperatur	- 25 °C			Lower temperature
Bemessungsspannung	125 V			Rated voltage
Bemessungs-Stoßspannung	1500 V			Rated impulse voltage
Verschmutzungsgrad	1			Pollution degree
Überspannungskategorie	II			Overvoltage categorie
Isolierstoffgruppe	III			Material group
Bemessungsstrom (40°C)	4 A	3 A	1 A	Rated current (40 °C)
Material Kontakt	CuZn (Messing/brass)			Material of contact
Kontaktoberfläche	Au (Gold/gold)			Contact plating
Material Kontaktkörper	PBT			Material of contact body
Material Gehäuse	PUR			Material of housing
Material Verriegelung	CuZn (Messing/brass)			Material of locking

Kabelstecker, umspritzt, geschirmt
Male cable connector, moulded, shielded



Winkelstecker, umspritzt, geschirmt
Male angled connector, moulded, shielded



Kabeldose, umspritzt, geschirmt
Female cable connector, moulded, shielded



Winkeldose, umspritzt, geschirmt
Female angled connector, moulded, shielded

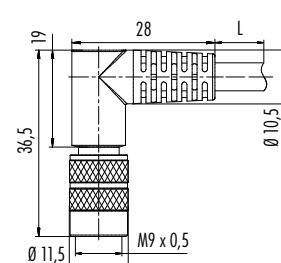
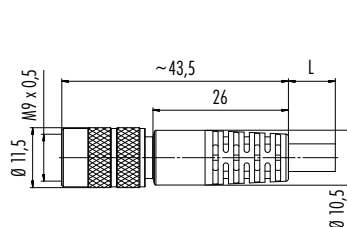
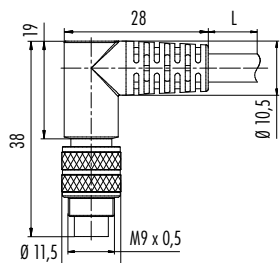
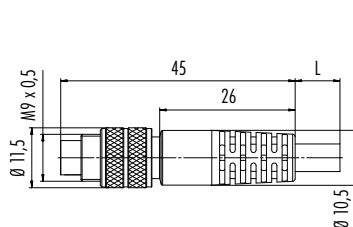

Polzahl Contacts	Kabellänge 2 m Cable length 2 m	Kabellänge 5 m Cable length 5 m	Polzahl Contacts	Kabellänge 2 m Cable length 2 m	Kabellänge 5 m Cable length 5 m	Polzahl Contacts	Kabellänge 2 m Cable length 2 m	Kabellänge 5 m Cable length 5 m	Polzahl Contacts	Kabellänge 2 m Cable length 2 m	Kabellänge 5 m Cable length 5 m
2	79 1401 12 02	79 1401 15 02	2	79 1401 72 02	79 1401 75 02	2	79 1402 12 02	79 1402 15 02	2	79 1402 72 02	79 1402 75 02
3	79 1405 12 03	79 1405 15 03	3	79 1405 72 03	79 1405 75 03	3	79 1406 12 03	79 1406 15 03	3	79 1406 72 03	79 1406 75 03
4	79 1409 12 04	79 1409 15 04	4	79 1409 72 04	79 1409 75 04	4	79 1410 12 04	79 1410 15 04	4	79 1410 72 04	79 1410 75 04
5	79 1413 12 05	79 1413 15 05	5	79 1413 72 05	79 1413 75 05	5	79 1414 12 05	79 1414 15 05	5	79 1414 72 05	79 1414 75 05
7	79 1421 12 07	79 1421 15 07	7	79 1421 72 07	79 1421 75 07	7	79 1422 12 07	79 1422 15 07	7	79 1422 72 07	79 1422 75 07
8	79 1425 12 08	79 1425 15 08	8	79 1425 72 08	79 1425 75 08	8	79 1426 12 08	79 1426 15 08	8	79 1426 72 08	79 1426 75 08

Technische Daten Kabel	2	3	4	5	7	8	Specifications of cable
Querschnitt mm ² ¹⁾	5 x 0,25 mm ² (AWG 24)				8 x 0,14 mm ² (AWG 26)		Wire gauge mm ² ¹⁾
Material Mantel	PUR						Material jacket
Isolation Litze	PP				PVC		Insulation wire
Litzenaufbau (mm)	32 x 0,1				18 x 0,1		Design of wire (mm)
Kabelmantel Ø (mm)	4,8 ^{+0,15}				5,4 ^{+0,2}		Cable jacket Ø (mm)
Leiterwiderstand	< 79 Ω/Km (20 °C)				< 148 Ω/Km (20 °C)		Resistance of wire
Temp.-Bereich (Kabel bew.)	- 25 °C /+ 90 °C				- 5 °C /+ 80 °C		Temp. range (cable in move)
Temp.-Bereich (Kabel fest)	- 50 °C /+ 90 °C				- 25 °C /+ 80 °C		Temp. range (cable fixed)
Biegeradius (Kabel bew.)	48 mm				405 mm		Bending radius (cable in move)
Biegeradius (Kabel fest)	24 mm				80 mm		Bending radius (cable fixed)
Zulassung	UL				—		Approval

Polzahl	2	3	4	5	7	8	Number of contacts
Steckverbinder Verriegelung	schrauben/screw						Connector locking system
Anschlussart	am Kabel angespritzt/moulded						Termination
Anschlussquerschnitt	0,25 mm ² (AWG 24)				0,14 mm ² (AWG 26)		Wire gauge
Kabeldurchlass	—						Cable outlet
Schutzart	IP67						Degree of protection
Mechanische Lebensdauer	> 500 Steckzyklen/> 500 mating cycles						Mechanical operation
Obere Grenztemperatur	+ 85 °C						Upper temperature
Untere Grenztemperatur	- 25 °C						Lower temperature
Bemessungsspannung	125 V						Rated voltage
Bemessungs-Stoßspannung	1500 V						Rated impulse voltage
Verschmutzungsgrad	1						Pollution degree
Überspannungskategorie	II						Overvoltage categorie
Isolierstoffgruppe	III						Material group
Bemessungsstrom (40°C)	4 A		3 A		1 A		Rated current (40 °C)
Material Kontakt	CuZn (Messing/brass)						Material of contact
Kontaktoberfläche	Au (Gold/gold)						Contact plating
Material Kontaktkörper	PBT						Material of contact body
Material Gehäuse	PUR						Material of housing
Material Verriegelung	CuZn (Messing/brass)						Material of locking

¹⁾ Vergleichbare AWG Leiter siehe technische Informationen. / ¹⁾ Comparable AWG conductors see technical information.

Montageanleitung
Assembly instruction

Gerade Kunststoffausführung
Straight plastic version

1. Druckschraube, Klemmkorb, Dichtring und Schnapphülse auf Kabel auffädeln.
2. Kabel abmanteln auf L = min. 10 bis max. 12 mm.
3. Litzen abisolieren und anlöten.
4. Schnapphülse mit Kontakteinsatz verschrauben.
5. Montierter Teil in Gewinding schieben und Gewinding mit Schnapphülse verschrauben.
6. Dichtring und Klemmkorb in Schnapphülse schieben und Druckschraube festziehen.
7. Gewinding auf Schnapphülse aufschnappen.

1. Bead pressing screw, pinch ring, seal and snap bush to cable.
2. Dismantle cable to min. 10 and max 12 mm length.
3. Strip and solder single wires.
4. Screw snap bush with contact insert.
5. Push the assembled part into the coupling ring and screw the coupling ring with the snap bush.
6. Push seal and pinch ring into snap bush and tighten pressing screw.
7. Snap coupling ring onto snap bush.

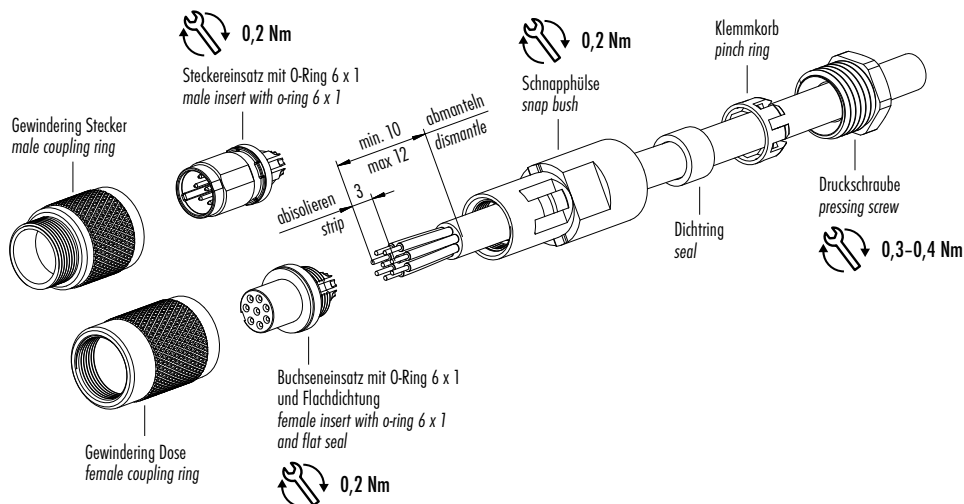

Gerade Metallausführung, EMV
Straight metal version, EMI

1. Kupplungshülse, Dichtring, Klemmkorb und Druckschraube auf Kabel auffädeln.
2. Kabel abmanteln auf L = min. 10 bis max. 12 mm.
3. Litzen abisolieren.
4. Schirm umlegen, Schirmmanschette an Kabeldurchmesser anpassen und mit Schirm verlöten. Überstehendes Geflecht abschneiden.
5. Litzen anlöten.
6. Kupplungshülse auf montierten Kontakteinsatz schrauben.
7. Druckschraube festziehen.

1. Bead male/female sleeve, seal, pinch ring and pressing screw to cable.
2. Dismantle cable to min. 10 and max 12 mm length.
3. Strip single wires.
4. Fold shield back, adjust shielding sleeve to cable diameter and solder it to shield. Cut off projecting shielding braid.
5. Solder single wires.
6. Screw the sleeve onto the assembled contact insert.
7. Tighten pressing screw.

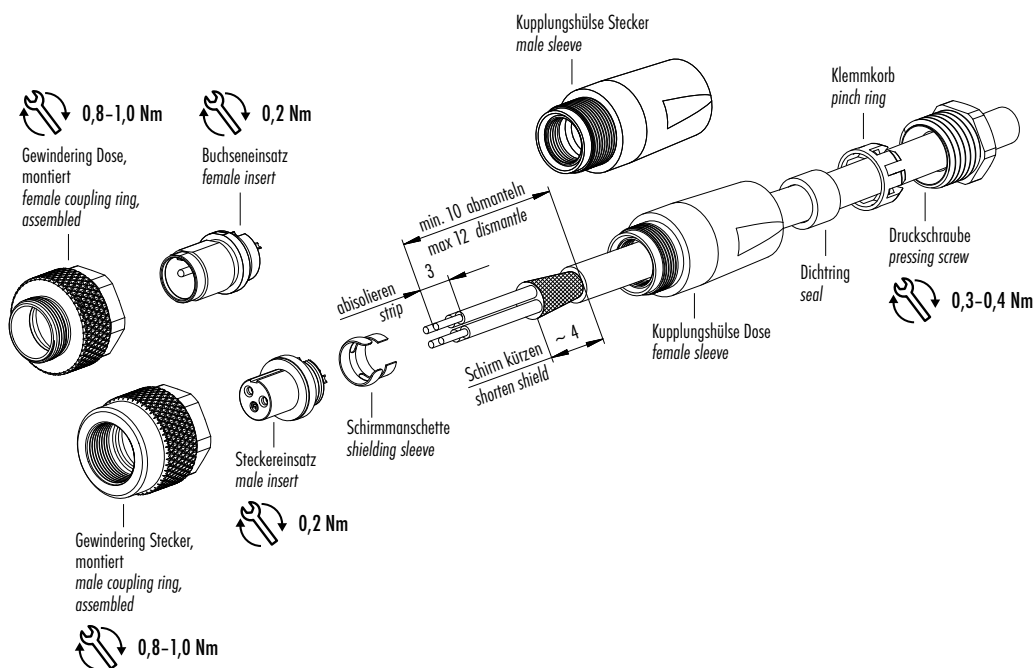

Montageanleitung
Assembly instruction

Gerade Metallausführung, EMV Ausführung mit Irisfeder-Schirmung
Straight metal version, EMI version with iris type spring

Schirmdurchmesser > 3,5 mm

1. Gehäuse auf Kabel auffädeln.
2. Litzen abisolieren, Schirm kürzen.
3. Litzen anlöten.
4. Gehäuse mit Kontakteinsatz verschrauben und Druckschraube festdrehen.

Shield-diameter > 3,5 mm

1. Bead housing to cable.
2. Strip single wires, shorten shielding braid.
3. Solder single wires.
4. Screw housing to contact insert and fix pressing screw.

Schirmdurchmesser > 3,5 mm
Shield-diameter > 3,5 mm

0,8-1,0 Nm

Gewinding Dose, montiert
female coupling ring, assembled

Buchseinsatz
female insert

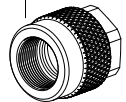

Steckereinsatz
male insert

Gewinding Stecker, montiert
male coupling ring, assembled

0,8-1,0 Nm

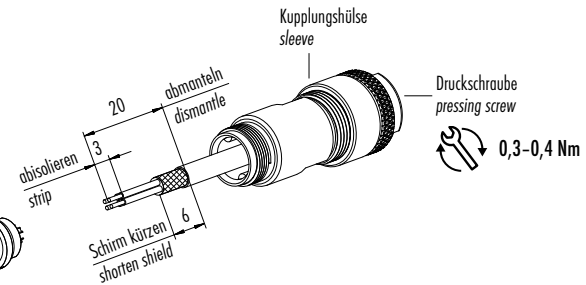

Kabeldurchlass 4-5,5 mm
Cable outlet 4-5,5 mm

Schirmdurchmesser ≤ 3,5 mm

1. Gehäuse auf Kabel auffädeln.
2. Abisolieren, Schirm kürzen, Schirm über Kabelmantel legen, mit Kupfer-Schirmfolie ca. 1 1/2 mal umwickeln und die Folie kürzen.
3. Litzen anlöten.
4. Gehäuse mit Kontakteinsatz verschrauben und Druckschraube festdrehen.

Shield-diameter ≤ 3,5 mm

1. Bead housing to cable.
2. Strip single cores, shorten shielding braid, put braid over cable coating, wrap it approx. 1 1/2 times with shielded copper tape and shorten tape.
3. Solder wires.
4. Screw housing to male or female contact carrier and fix pressing screw.

Schirmdurchmesser ≤ 3,5 mm
Shield-diameter ≤ 3,5 mm

0,8-1,0 Nm

Gewinding Dose, montiert
female coupling ring, assembled

Buchseinsatz
female insert

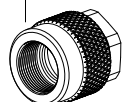

Steckereinsatz
male insert

Gewinding Stecker, montiert
male coupling ring, assembled

0,8-1,0 Nm

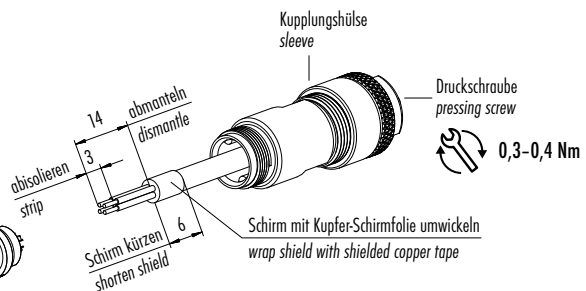

Montageanleitung
Assembly instruction

Gewinkelte Kunststoffausführung
Angled plastic version

1. Teile auf Kabel auffädeln.
2. Abmanteln auf L = 12 mm.
3. Litzen absolieren (L = 3 mm).
4. Litzen durch Gehäuse fädeln.
Dichtring und Klemmkorb montieren, Druckschraube andrehen.
5. Litzen anlöten.
6. Gehäuse mit Kontakteinsatz verschrauben und Druckschraube festdrehen.

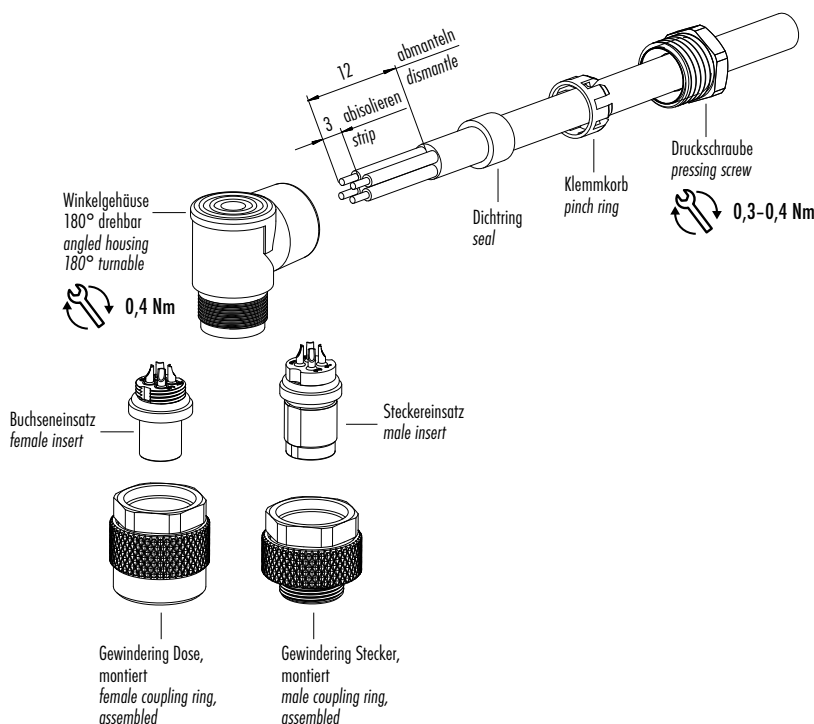

1. Bead parts to cable.
2. Dismantle cable to 12 mm length.
3. Strip single wires (L = 3 mm).
4. Bead single wires through housing.
Mount seal and pinch ring, turn on pressing screw.
5. Solder single wires.
6. Screw housing to contact insert and tighten pressing screw.

Gewinkelte Metallausführung, EMV
Angled metal version, EMI

1. Teile auf Kabel auffädeln.
2. Abmanteln auf L = 25 mm.
3. Litzen absolieren (L = 3 mm), Schirm aufweiten und um Schirmring legen.
4. Litzen durch Gehäuse fädeln.
Schirmring, Dichtring und Klemmkorb montieren.
Druckschraube andrehen, um das Kabel zu fixieren.
5. Litzen anlöten.
6. Gehäuse mit Kontakteinsatz verschrauben und Druckschraube festdrehen.
7. Verschlusschraube anziehen.

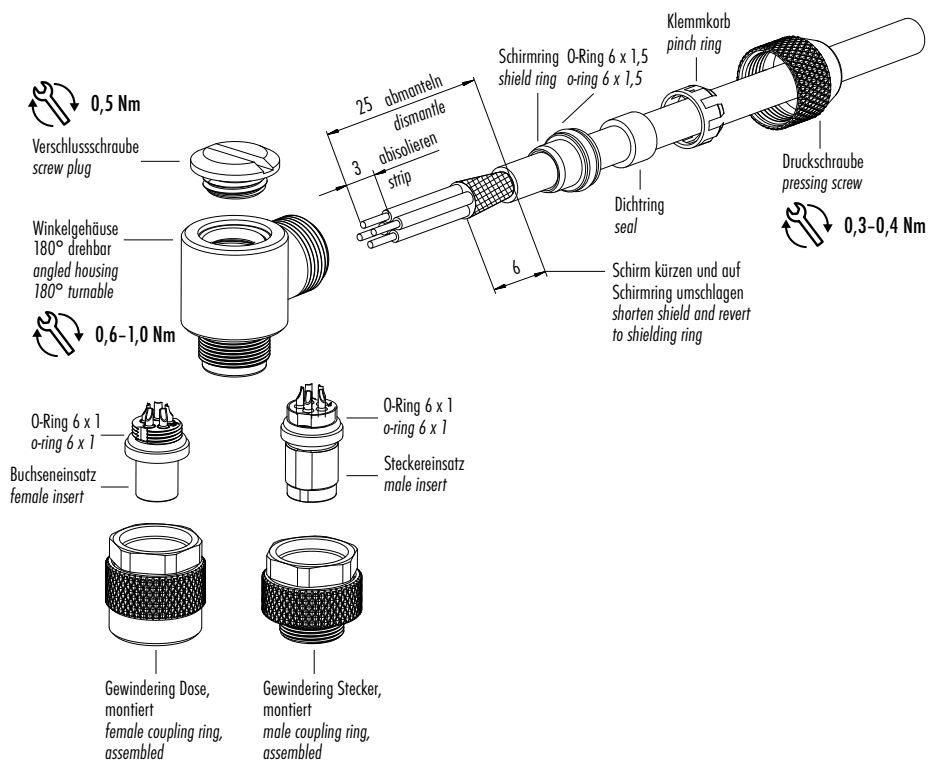

1. Bead parts to cable.
2. Dismantle cable to 25 mm length.
3. Strip single wires (L = 3 mm), widen shield and revert to shielding ring.
4. Bead single wires through housing. Mount shielding ring, seal and pinch ring. Turn on pressing screw to fix the cable.
5. Solder single wires.
6. Screw housing to contact insert and tighten pressing screw.
7. Tighten screw plug.

Einzelteildarstellung
Component part drawing

Flanschsteckverbinder, löten
Panel mount connectors, solder

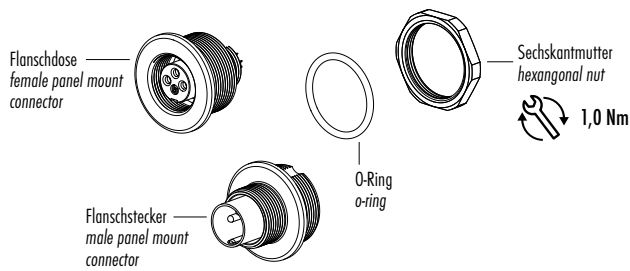

Flanschsteckverbinder, löten, von vorn verschraubbar
Panel mount connectors, solder, dip solder, front fastened

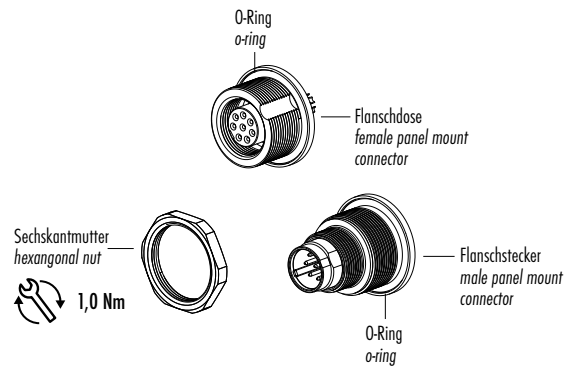

Flanschsteckverbinder, tauchlöten, von vorn verschraubbar
Panel mount connectors, dip solder, front fastened

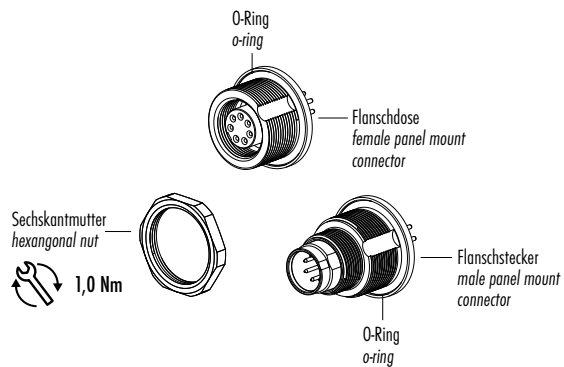

Flanschsteckverbinder, tauchlöten, von vorn verschraubbar, mit Schirmblech
Panel mount connectors, dip solder, front fastened, with shielding sheet

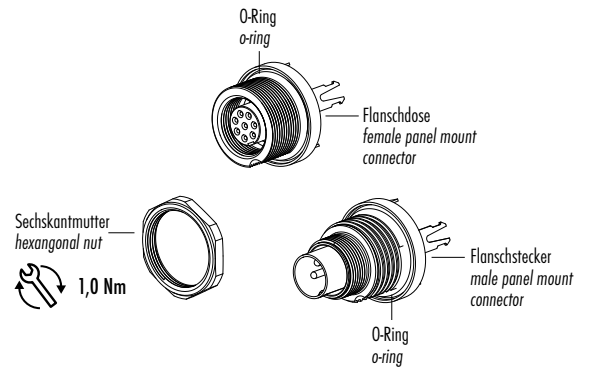

Polbilder
Contact arrangements

Stifteinsatz (Steckseite)
Male insert (mating side)

Buchseinsatz (Steckseite)
Female insert (mating side)

2 pol
2 contacts

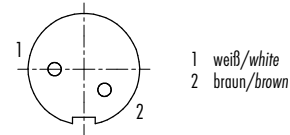
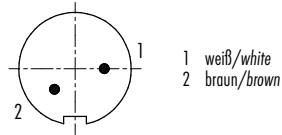

3 pol
3 contacts

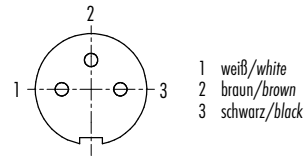
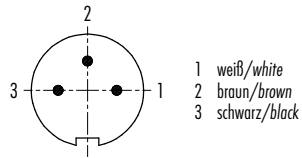

4 pol
4 contacts

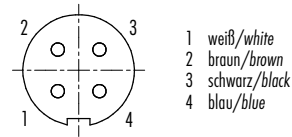
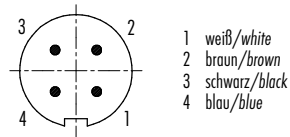

5 pol
5 contacts

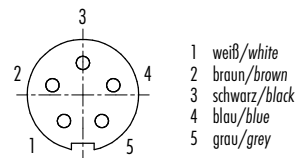
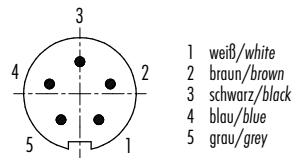

7 pol
7 contacts

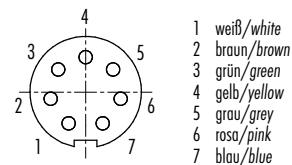
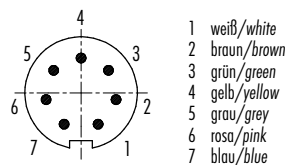

8 pol
8 contacts

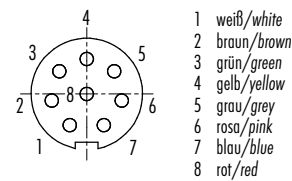
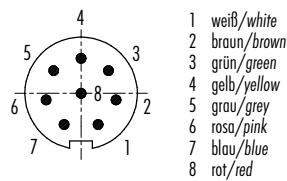

Montageausschnitt
Panel cut out

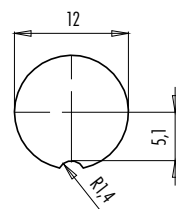

Bohrbilder Stifteinsatz (Leiterplatte), Schirmblechvariante
Drilling schemes male insert (PCB), shielding sheet

Bohrbilder Buchseneinsatz (Leiterplatte), Schirmblechvariante
Drilling schemes female insert (PCB), shielding sheet

2 pol
2 contacts

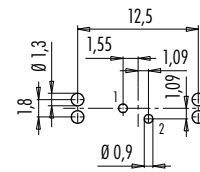
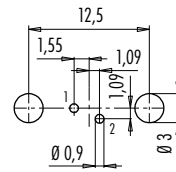
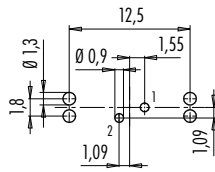
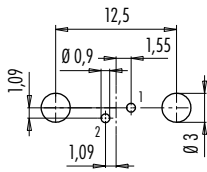

Winkelversion
Angled version

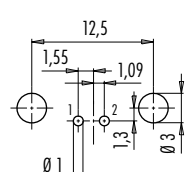

3 pol
3 contacts

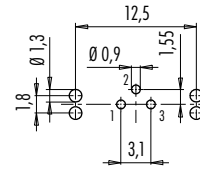
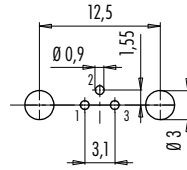
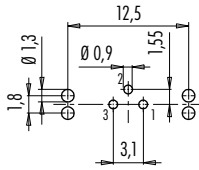
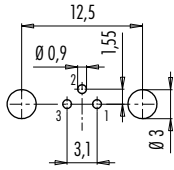

4 pol
4 contacts

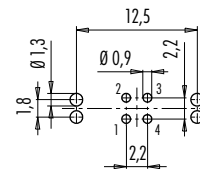
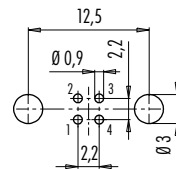
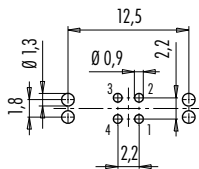
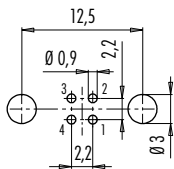

5 pol
5 contacts

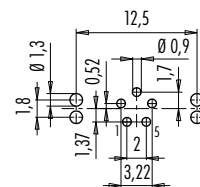
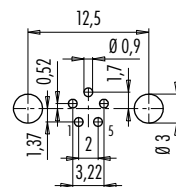
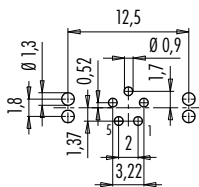
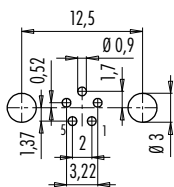

Winkelversion
Angled version

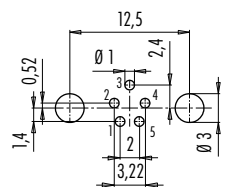

7 pol
7 contacts

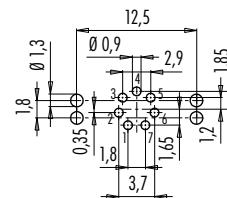
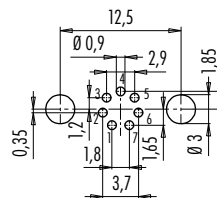
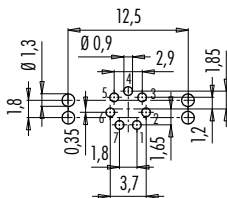
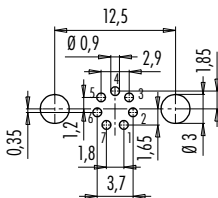

8 pol
8 contacts

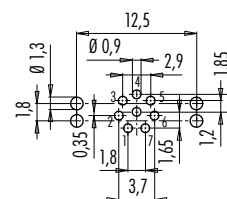
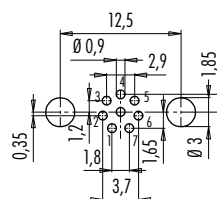
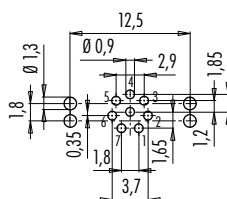
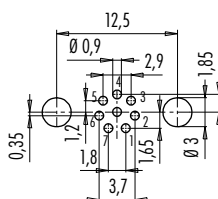

Zeichnungen
Drawings

09 0423 65 07

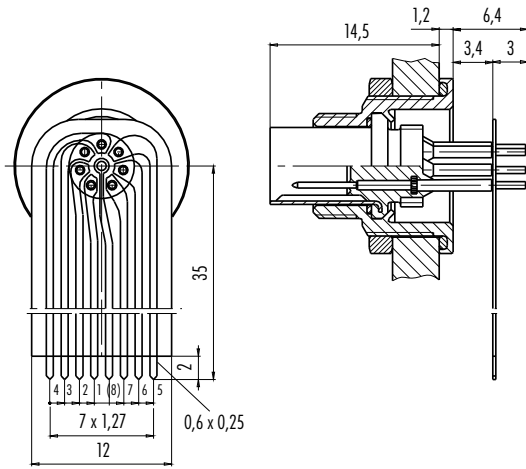

09 0424 65 07

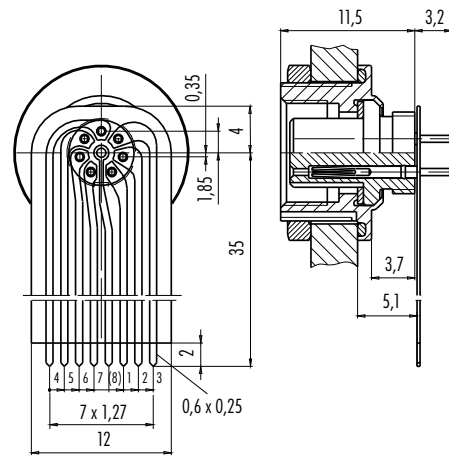

09 0427 65 08

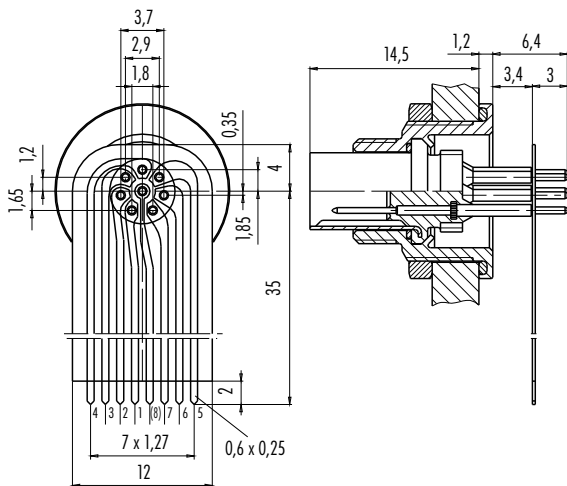

09 0428 65 08

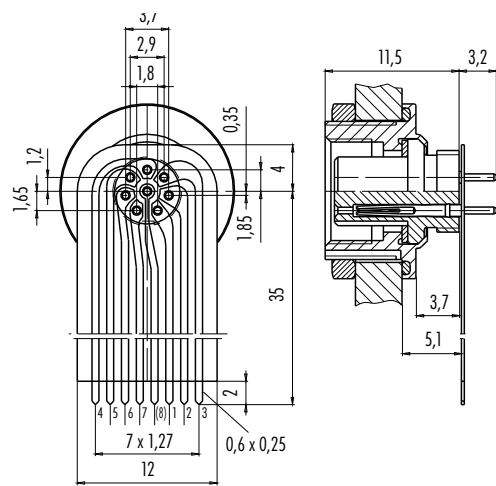

Bezeichnung / Description	Maßzeichnung / Drawing	Bestell-Nr. / Ordering-No.						
Schutzkappe für Kabelstecker Protection cap for male cable connector		08 0349 000 001						
Schutzkappe für Kabeldose Protection cap for female cable connector		08 0350 000 001						
Schutzkappe für Flanschstecker Protection cap for male panel mount connector		08 0351 000 001						
Schutzkappe für Flanschdose Protection cap for female panel mount connector		08 0352 000 001						
Viereckflansch mit Dichtung Square flange with seal		08 1124 000 001						
Lötösenring Solder eye ring		04 0208 002						
Sechskantmutter mit Rändel 2mm, 4mm Knurled hexagon nut 2mm, 4mm		<table border="1"> <thead> <tr> <th data-bbox="1157 1500 1284 1534">Stärke / Thickness</th> <th data-bbox="1316 1534 1516 1568"></th> </tr> </thead> <tbody> <tr> <td data-bbox="1157 1556 1284 1590">2 mm</td> <td data-bbox="1316 1534 1516 1568">01 0013 001</td> </tr> <tr> <td data-bbox="1157 1646 1284 1680">4 mm</td> <td data-bbox="1316 1646 1516 1680">01 5023 001</td> </tr> </tbody> </table>	Stärke / Thickness		2 mm	01 0013 001	4 mm	01 5023 001
Stärke / Thickness								
2 mm	01 0013 001							
4 mm	01 5023 001							
Montageschlüssel Mounting spanner		01 5059 001						
Adapter Schaltschrank-durchführung Adapter lead-through for control cabinet		09 9618 100 05						